



PARTS & SERVICE MANUAL
MODEL 690F

Document: 690F Parts Manual Rev. 1.6

Covers Serial Number Range:

999-B-69TKS8Y2-00999 thru _____

SOLD & SERVICED BY



TABLE OF CONTENTS

<u>ITEM</u>	<u>PAGE</u>
Quick Order Page	2
Dash Assembly	3
Engine Compartment	4
Engine Assembly – Left Side	5
Engine Assembly – Right Side	6
Hopper Assembly – Left Side	7
Hopper Assembly – Right Side	8
Hopper Assembly – Center	9
Screed Assembly – Front	10
Screed Assembly – Rear	11
Vibrator Assembly	12
Track Assembly	13
Idler Assembly	13
Drive Assembly	13
Battery Assembly	14
Propane Assembly	14
Tire Assembly (Optional)	15

Serial Number Range: 999-B-69TKS8Y2-00999 thru _____

QUICK ORDER PAGE

Auger Hanger Support Assembly.....	111-200080
Auger Hanger Support Bearing.....	018-0103
Auger Coupling Chain (x2)	015-0045
Auger Coupling Half (x2)	015-0154
Auger (LH).....	092-0014
Auger (RH)	092-0013
Battery	020-0019
Cable, Steering (x2)	050-0341
Cable, Throttle.....	050-0347
Cap (Fuel Tank)	050-0522
Cap (Hydraulic Tank)	060-0069
Cap (Wash Down Tank).....	050-0188
Cut Off Plate (1'LH).....	CALL DEALER
Cut Off Plate (1'RH)	CALL DEALER
Cut Off Plate (2'LH).....	CALL DEALER
Cut Off Plate (2'RH)	CALL DEALER
Cut Off Plate (3'LH).....	CALL DEALER
Cut Off Plate (3'RH)	CALL DEALER
Decal Kit.....	024-0026
Alternator / Fan Belt	010-0407
Filter, Engine Oil.....	021-0132
Filter, Fuel (In-Line)	021-0068
Filter, Fuel / Water Separator (Spin -On)	021-0078
Filter, Hydraulic Oil (High Pressure).....	021-0169
Key Switch	020-0156
Plastic, Front Hopper	015-0222
Push Roller Assembly (x2).....	091-0006
Screed Burner Assembly (x2)	093-0217
Screed Lighting Torch Assembly	090-0231
Screed Plate (Freedom)	111-200008
Spare Key (Set)	020-0087
Spray Nozzle.....	050-0051
Sprocket, Drive (x2)	093-0325
Sprocket, Idler Assembly (x2)	093-0326
Track Roller (x6).....	050-0257

Serial Number Range: 999-B-69TKS8Y2-00999 thru _____

DASH ASSEMBLY

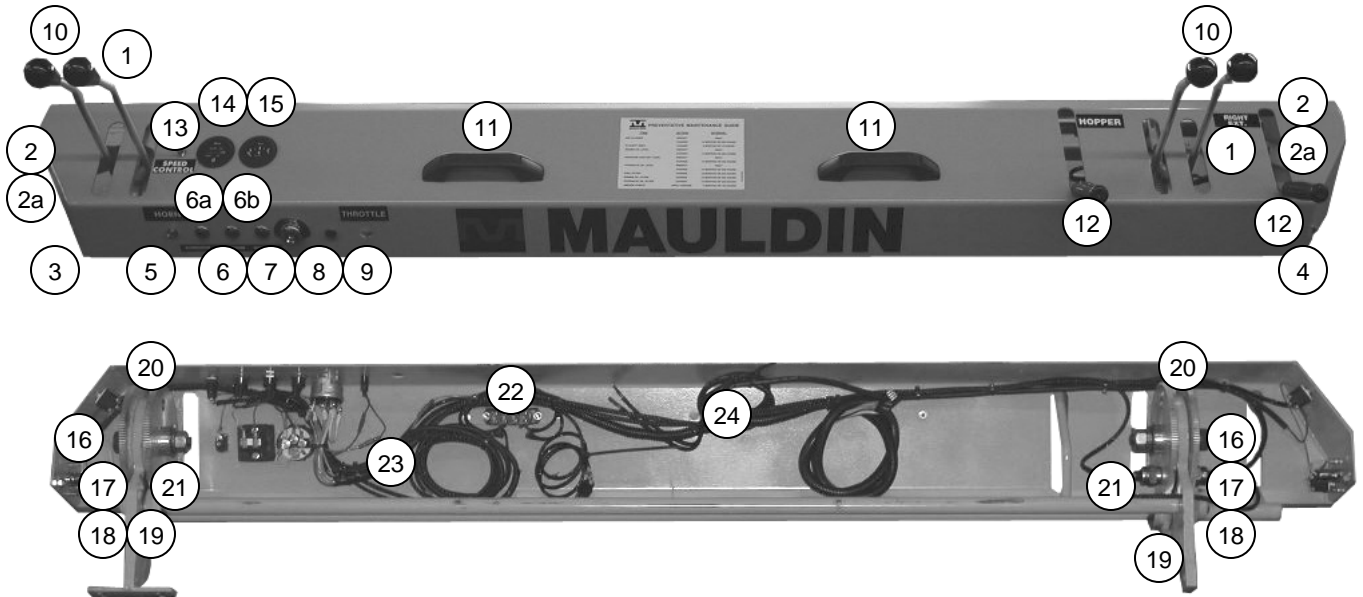

1. Steering Handle (x4)	093-0318
2. Auto Auger Cord Assembly (x2) (not shown)	See Hopper Left
a. Auto Auger Toggle Switch (x2)	020-0405
3. Left Auger Toggle Switch	020-0083
4. Right Auger Toggle Switch	020-0083
5. Horn Toggle Switch	020-0423
6. Alternator Indicator Light	020-0398
a. Oil Pressure Indicator Light	020-0400
b. Temperature Indicator Light	020-0399
7. Starter Switch	020-0156
8. Neutral Indicator Light	020-0140
9. Throttle Cable (not shown)	See Engine Right
10. Steering Handle Knob (x4)	050-0388
11. Dash Safety Handle (x2)	050-0205
12. Rubber Handle Grip (x2)	050-0282
13. Speed Control Toggle Switch	020-0082
14. Hour Meter Gauge	020-0173
15. Fuel Meter Gauge	020-0170
16. Shoulder Bolt (x2)	030-0473
17. Set Collar (x2)	030-0447
18. Steering Rod Bearing (x4)	018-0011
19. Fiber Composite Steering Gear (x4)	093-100075
20. Aluminum Steering Gear (x2)	093-100074
21. Neutral Switch (x2)	020-0002
22. Fuse Box	020-0407
23. Starter Switch Electrical Harness Assembly	010-0311
24. Auto Auger Electrical Harness Assembly (x2)	010-0263

Serial Number Range: 999-B-69TKS8Y2-00999 thru _____

ENGINE COMPARTMENT

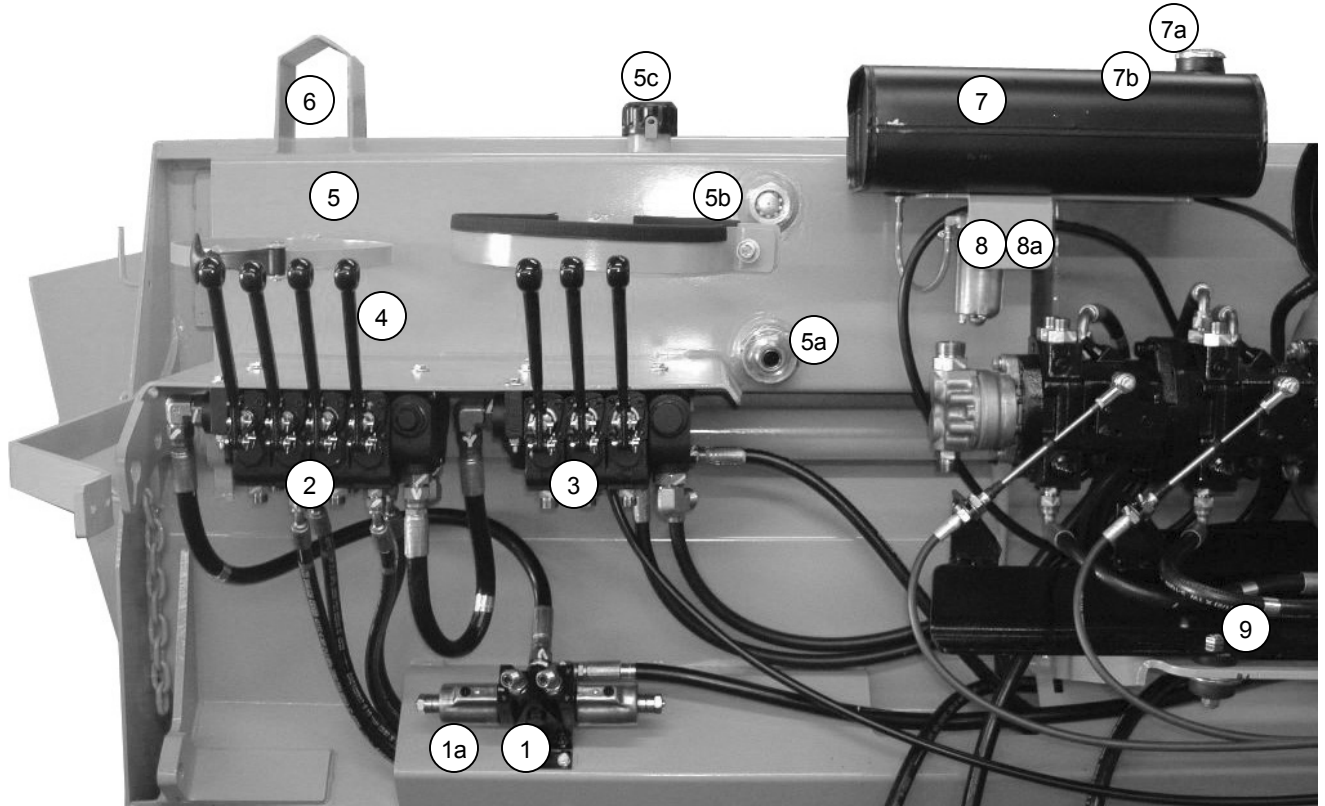

1. Auger Motor Solenoid Valve (x2)	017-0008
a. Auger Motor Solenoid Valve Coil (x4).....	017-0090A
2. 4 Station Valve Bank Assembly	017-0169
3. 3 Station Valve Bank Assembly	017-0170
4. Valve Bank Handle (x7).....	017-0060
5. Hydraulic Tank Assembly.....	091-200128
a. Hydraulic Tank Outlet Strainer	021-0186
b. Hydraulic Tank Sight Window.....	060-0066
c. Hydraulic Tank Cap	060-0069
6. Horn	<i>See Hopper Center</i>
7. Washdown Tank	050-0027
a. Washdown Tank Cap	050-0188
b. Washdown Tank Clamp (x2) (not shown).....	015-0219
8. Washdown Pump.....	011-0082
a. Washdown Pump Toggle Switch.....	020-0082
9. Rubber Engine Mount (x4)	<i>See Engine Left</i>

Serial Number Range: 999-B-69TKS8Y2-00999 thru _____

ENGINE ASSEMBLY – LEFT SIDE

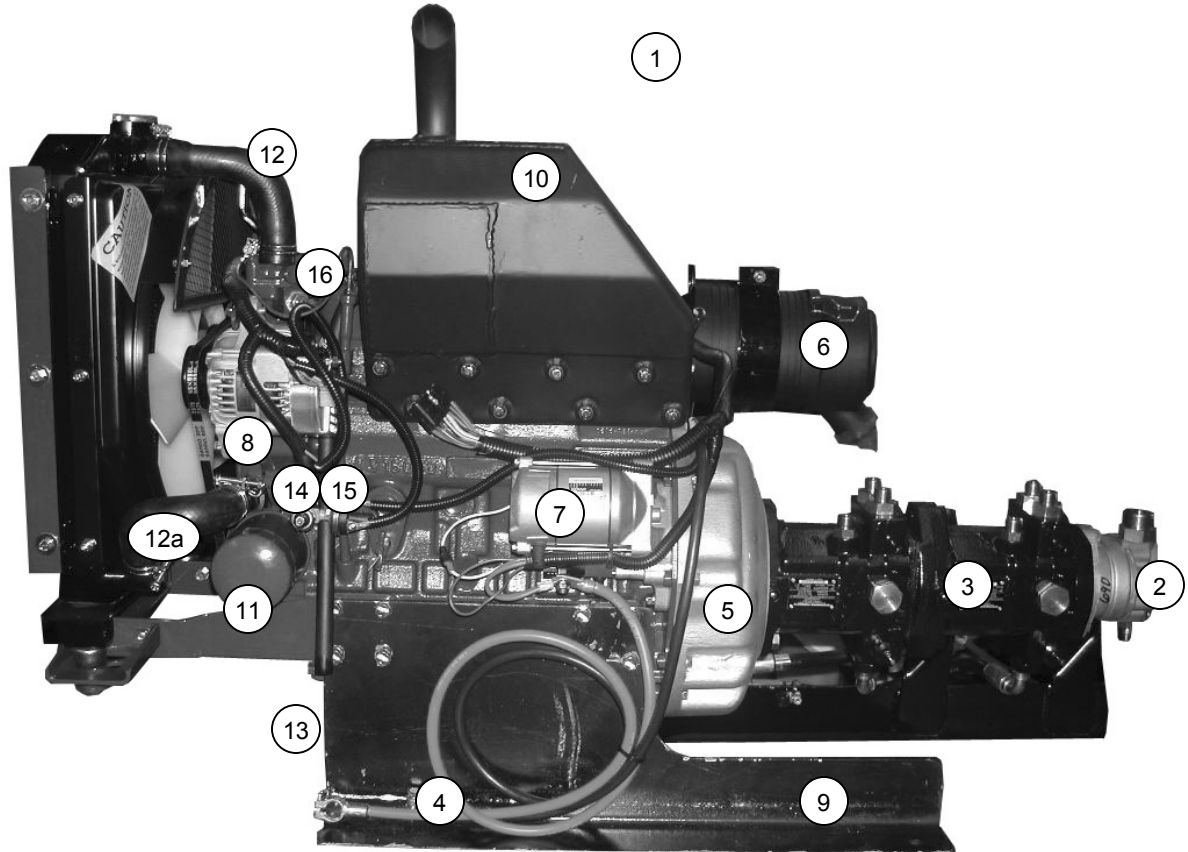

1. Kubota V1505 Engine	010-0213
2. Auxiliary Pump	011-0152
3. Main Drive Pump	011-0150
4. Battery Cable (x2)	See Battery Assy.
5. Flywheel Adapter / Pump Mount Kit	See Engine Right
6. Air Filter Assembly	See Engine Right
7. Starter.....	010-0269
8. Alternator.....	010-0435
9. Engine Leg (Left Side / Front)	093-100056
10. Muffler Assembly.....	010-0333
11. Oil Filter	021-0132
12. Radiator Hose (Upper)	010-0254
a. Radiator Hose (Lower)	010-0255
13. Engine Mount (x4) (not shown)	050-0260
14. Oil Pressure Sender	020-0180
15. Oil Pressure Switch	021-0168
16. Temperature Sender	010-0436

Serial Number Range: 999-B-69TKS8Y2-00999 thru _____

ENGINE ASSEMBLY – RIGHT SIDE

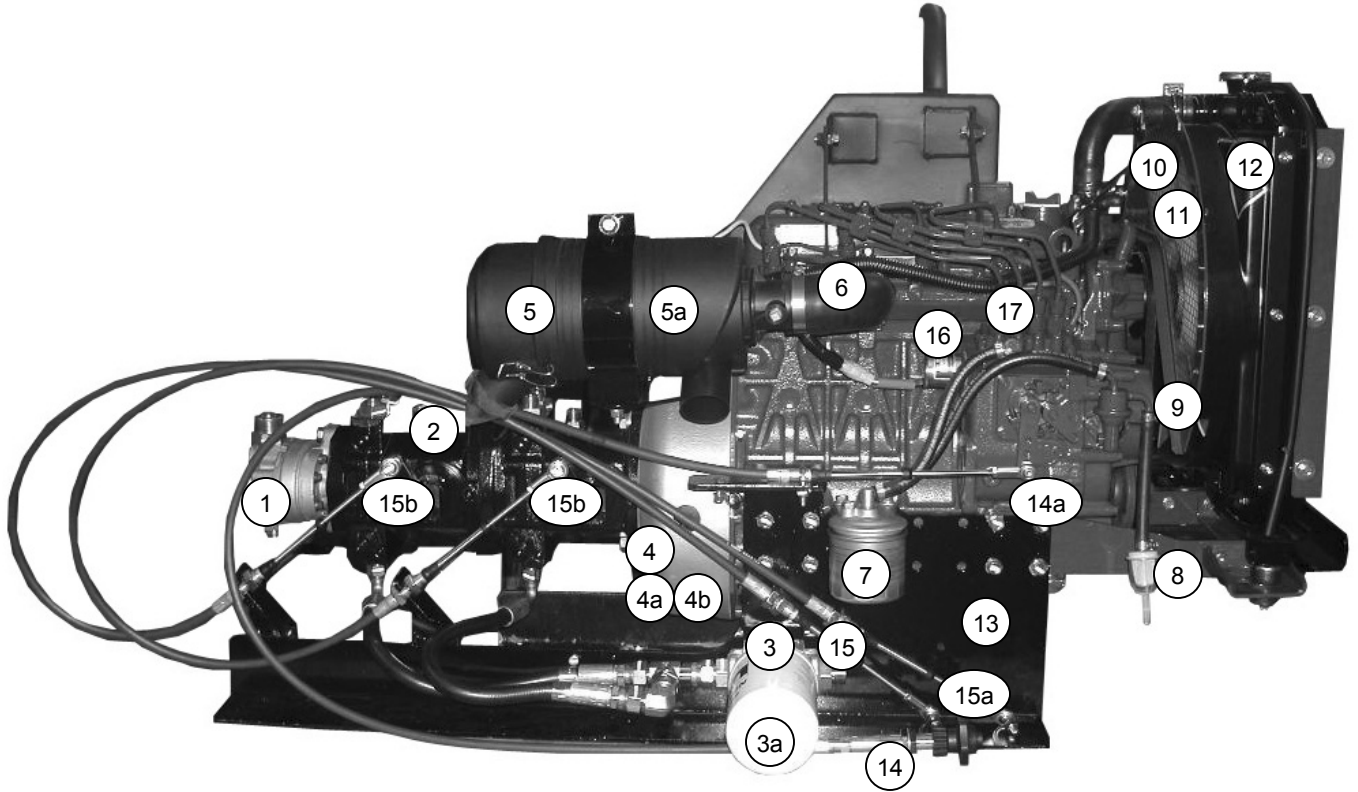

1. Auxiliary Gear Pump.....	See Engine Left
2. Main Pump.....	See Engine Left
3. Hydraulic Filter Head (High Pressure)	021-0192
a. Hydraulic Filter Element (High Pressure).....	021-0169
4. Flywheel Adaptor / Pump Mount	010-0434
a. Hydraulic Pump Mount	010-0434A
b. Flywheel Adapter Plate.....	010-0434B
5. Air Filter Assembly Kit	021-0201
a. Air Filter Element.....	021-0195
6. Inlet Pipe.....	010-0417
7. Fuel Filter.....	021-0078
8. Inline Fuel Filter	021-0068
9. Alternator / Fan Belt.....	010-0407
10. Engine Fan	010-0326
11. Engine Fan Cover.....	010-0416
12. Radiator	010-0253
13. Engine Leg (Right Side / Back)	093-100055
14. Throttle Cable	050-0347
a. Throttle Cable Ball Joint	050-0120
15. Steering Cable (x2).....	050-0341
a. Steering Cable Ball Joint (with stud) (x2)	030-0237
b. Steering Cable Ball Joint (without stud) (x2)	030-0430
16. Fuel Shutdown Solenoid.....	011-0220
17. Fuel Pump	010-0368

Serial Number Range: 999-B-69TKS8Y2-00999 thru _____

HOPPER ASSEMBLY – LEFT SIDE

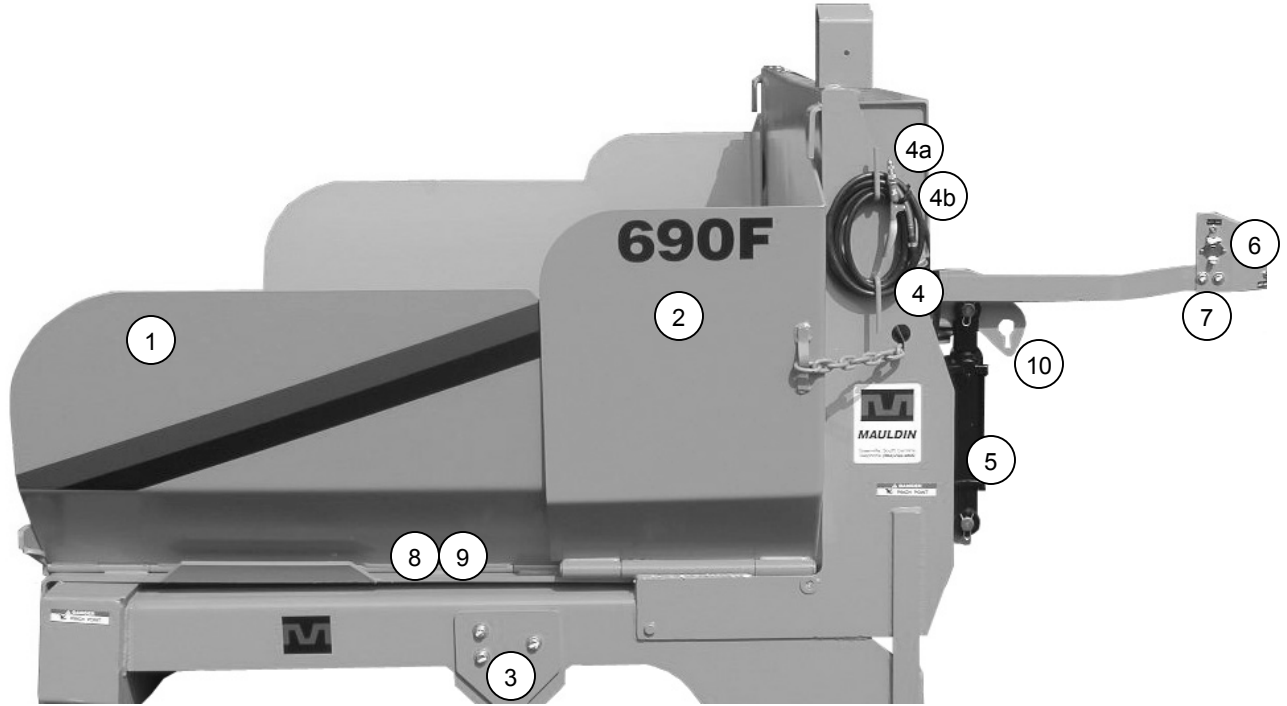

- | | |
|--|------------------|
| 1. Front Hopper Flap Assembly (LH)..... | 092-100251 |
| 2. Rear Hopper Flap Assembly (LH)..... | 092-100242 |
| 3. Screed Arm Mounting Plate | See Hopper Right |
| 4. Wash Down Hose Assembly | See Hopper Right |
| a. Spray Nozzle | See Hopper Right |
| b. Spray Nozzle Tip | See Hopper Right |
| 5. Screed Lift Cylinder..... | 012-0005 |
| 6. Four Pole Connector Set (x2)..... | 020-0315 |
| 7. Auto Auger Asphalt Level Detection Switch Assembly (not shown) .. | See Screed Front |
| 8. Hopper Flap Hinge Rod (x2) | See Hopper Right |
| 9. Hopper Flap Hinge Pipe (x14)..... | See Hopper Right |
| 10. Screed Lift Chain (x2) (not shown)..... | 093-0400 |

Serial Number Range: 999-B-69TKS8Y2-00999 thru _____

HOPPER ASSEMBLY – RIGHT SIDE

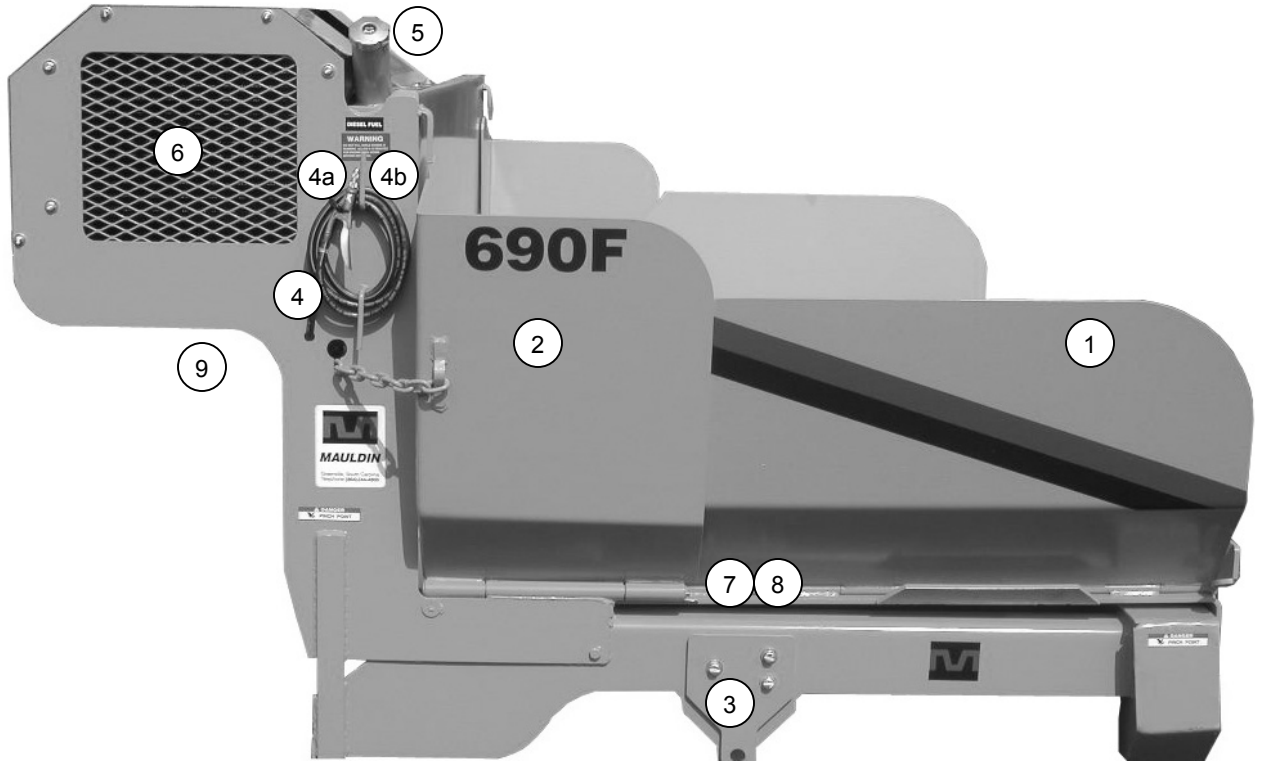

1. Front Hopper Flap Assembly (RH)	092-100251A
2. Rear Hopper Flap Assembly (RH).....	092-100242A
3. Screed Arm Mounting Plate	093-200176
4. Wash Down Hose Assembly	050-0051A
a. Spray Nozzle	050-0051
b. Spray Nozzle Tip	050-0103
5. Fuel Tank Cap.....	050-0522
6. Oil Cooler	050-0157
7. Hopper Flap Hinge Rod.....	093-202030
8. Hopper Flap Hinge Pipe (x14).....	093-202028
9. Screed Lift Chain Assembly (x2) (not shown)	See Hopper Right

Serial Number Range: 999-B-69TKS8Y2-00999 thru _____

HOPPER ASSEMBLY – CENTER

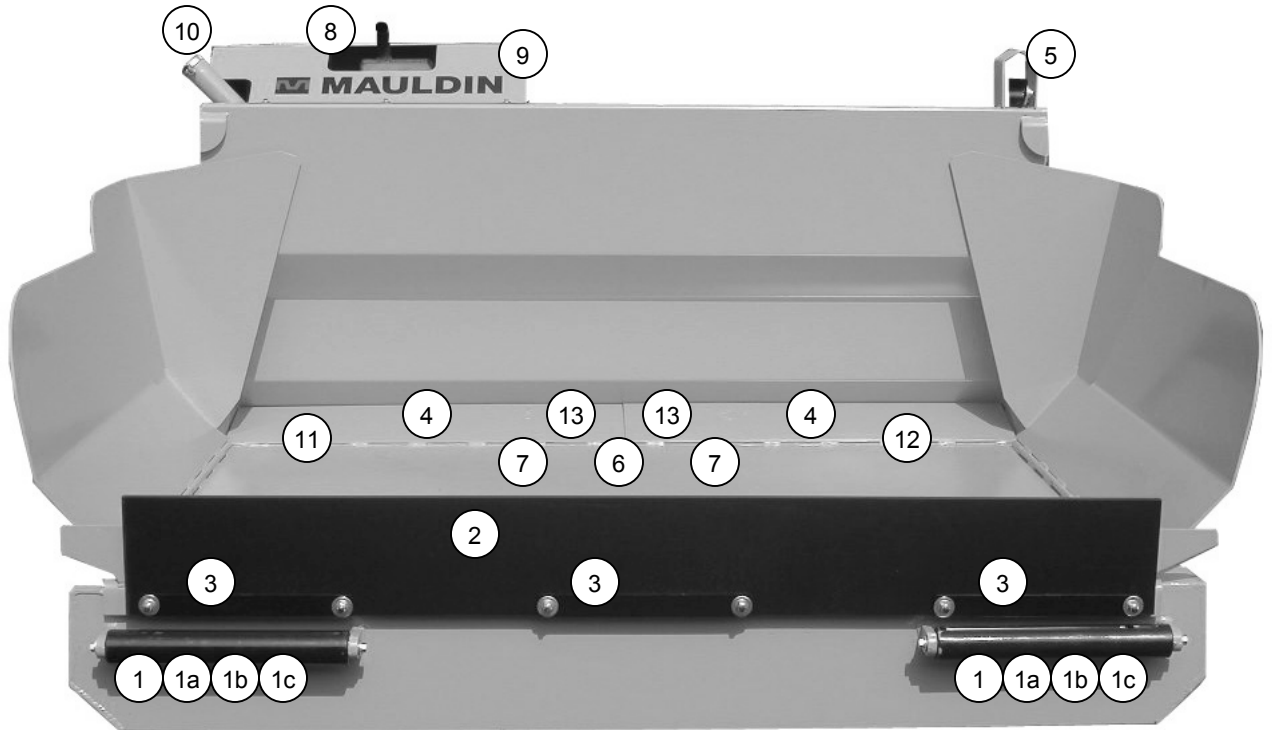

1. Push Roller Assembly (x2)	091-0006
a. Push Roller 20" (x2).....	091-0006A
b. Push Roller Shaft 22" (x2)	093-0038
c. Push Roller bearing (x4).....	018-0010
2. Front Plastic	015-0222
3. Front Plastic Retainer (x3).....	093-100305
4. Hopper Flow Gate Assembly (x2)	092-0124
5. Horn	020-0410
6. Hopper Bed Assembly.....	092-100574
7. Hopper Bed Lift Cylinder (x2) (located under hopper bed)	012-0008
8. Muffler Assembly.....	010-0333
9. Engine Cover	091-200190
10. Fuel Tank Cap.....	<i>See Hopper Right</i>
11. Hopper Bed Hinge Rod	093-100572
12. Hopper Bed Hinge Pipe (x42)	093-100573
13. Hopper Flow Gate Lift Cylinder (x2) (not shown)	012-0005

Serial Number Range: 999-B-69TKS8Y2-00999 thru _____

SCREED ASSEMBLY – FRONT

Left Side Shown

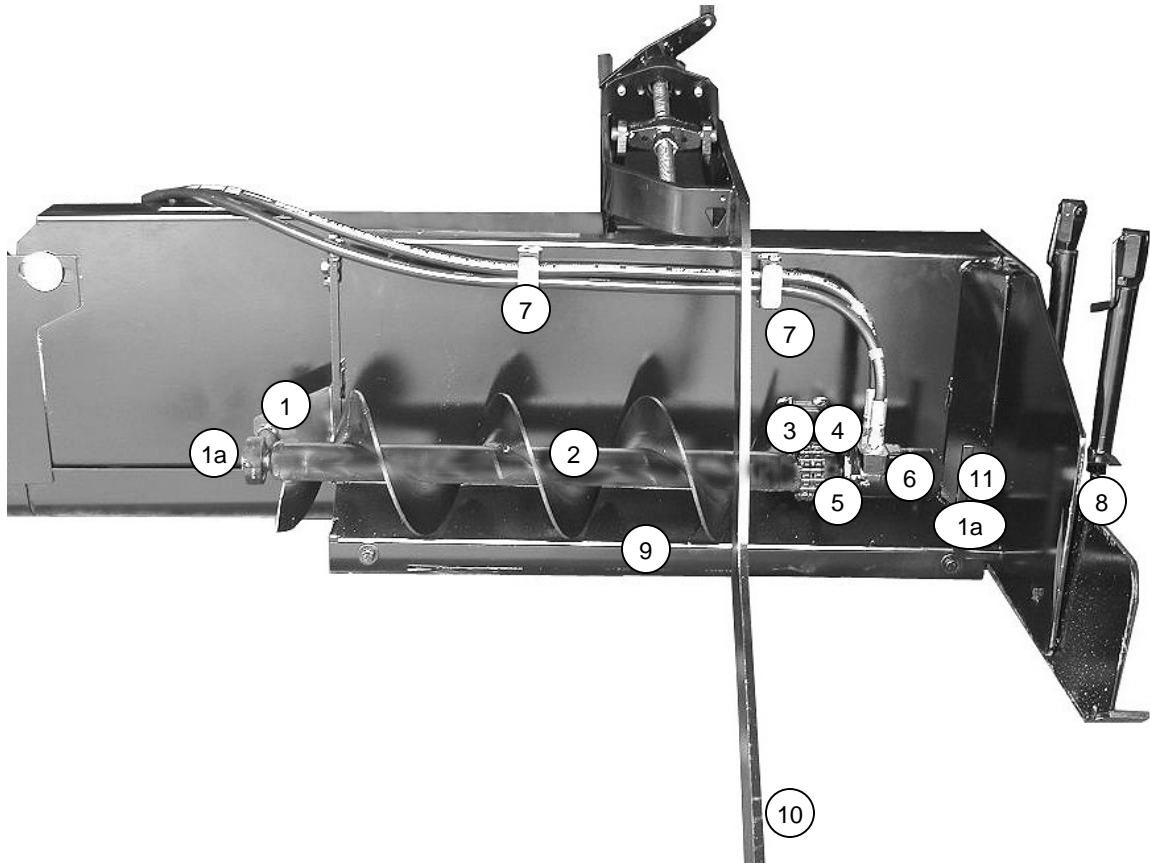

- | | | |
|-----|---|-----------------|
| 1. | Auger Hanger Support Assembly (x2) | 111-200080 |
| a. | Auger Hanger Support Bearing (x2) | 018-0105 |
| 2. | Auger (LH) | 092-0014 |
| a. | Auger (RH) (not shown) | 092-0013 |
| 3. | Auger Motor Coupling Chain (x2) | 015-0045 |
| 4. | Auger Motor Coupling Half (x2) | 015-0154 |
| 5. | Auger Motor Support Assembly (x2) | 111-200072 |
| 6. | Auger Motor (x2) | 013-0082 |
| 7. | Hose Guide Clamp (x4) | 050-0343 |
| 8. | End Gate Jointing Shoe Assembly (LH) | 092-0021A |
| a. | End Gate Jointing Shoe Assembly (RH) (not shown) | 092-0022A |
| 9. | Extension Wear Plate (x2) | 111-200030 |
| 10. | Tow Arm Assembly (LH) | 111-200053 |
| a. | Tow Arm Assembly (RH) (not shown) | 111-200052 |
| 11. | Auto Auger Asphalt Level Detection Switch Assembly (x2) (not shown) | 020-0357A |
| a. | Auto Auger Asphalt Level Detection Switch (x2) (not shown) | 020-0357 |
| b. | Auto Auger Cord Assembly (x2) (not shown) | 050-0304A |
| i. | Detection Switch Strain Relief Connector (x2) (not shown) | 020-0303 |
| ii. | Four Poll Connector Set (x2) (not shown) | See Hopper Left |

Serial Number Range: 999-B-69TKS8Y2-00999 thru _____

SCREED ASSEMBLY – REAR

Left Side Shown

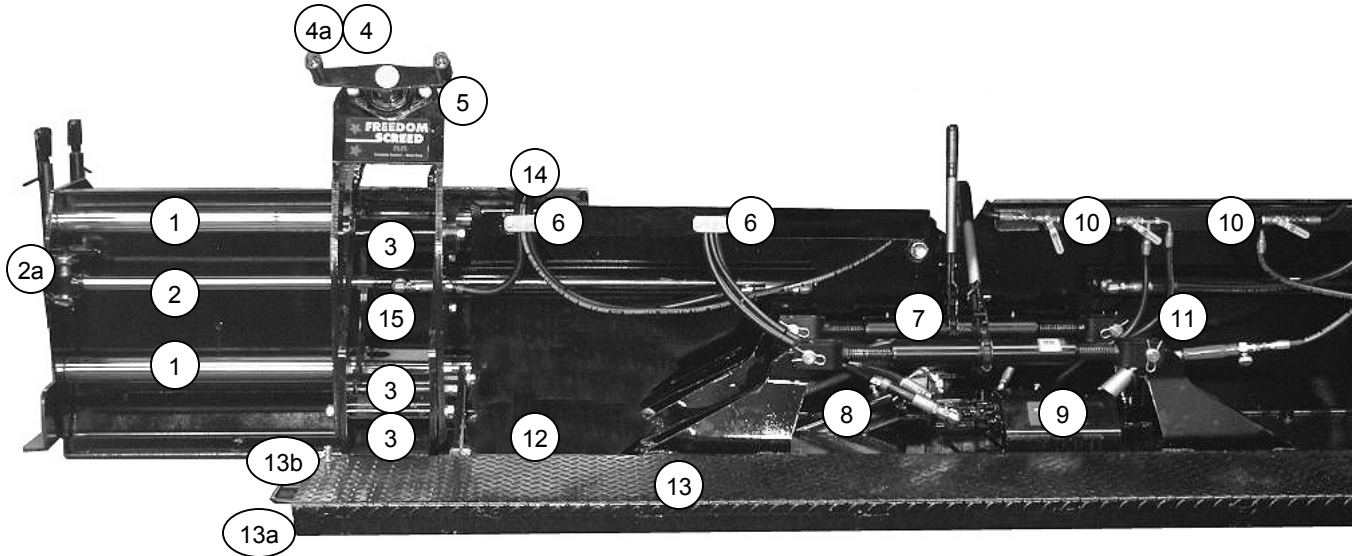

1. Extension Guide Bar (In/Out) (x4)	113-100169
2. Extension Cylinder (x2)	012-0067
a. Extension Cylinder Pin (x2)	030-0413
3. Pivot Pin (x6).....	111-200018
4. Screed Depth Adjusting Handle Assembly (x2).....	111-200070
a. Screed Depth Adjusting Handle Plastic Knob (x4).....	113-100427
5. Screed Depth Adjusting Pivot Block (not shown) (x2)	111-200060
6. House Guide Clamp (x3).....	050-0415
7. Ratchet Jack (x2)	050-0147
8. Screed Burner Assembly (x2)	<i>See Propane Assy.</i>
9. Vibrator Assembly	<i>See Vibrator Assy.</i>
10. Ball Valve (x3)	050-0154
11. Lighting Torch Assembly	<i>See Propane Assy.</i>
12. Main Screed Bottom Plate.....	111-200008
13. Walkboard Assembly	111-200100
a. Walkboard Extension (x2)	111-100701
b. Walkboard Extension Ball Lock Pin (x2).....	030-0461
14. Extension Burner Propane Tubing (x2) (not shown)	<i>See Propane Assy.</i>
15. Freedom Adjusting Link Assembly (LH).....	111-200013
a. Freedom Adjusting Link Assembly (RH).....	111-200012

Serial Number Range: 999-B-69TKS8Y2-00999 thru _____

VIBRATOR ASSEMBLY

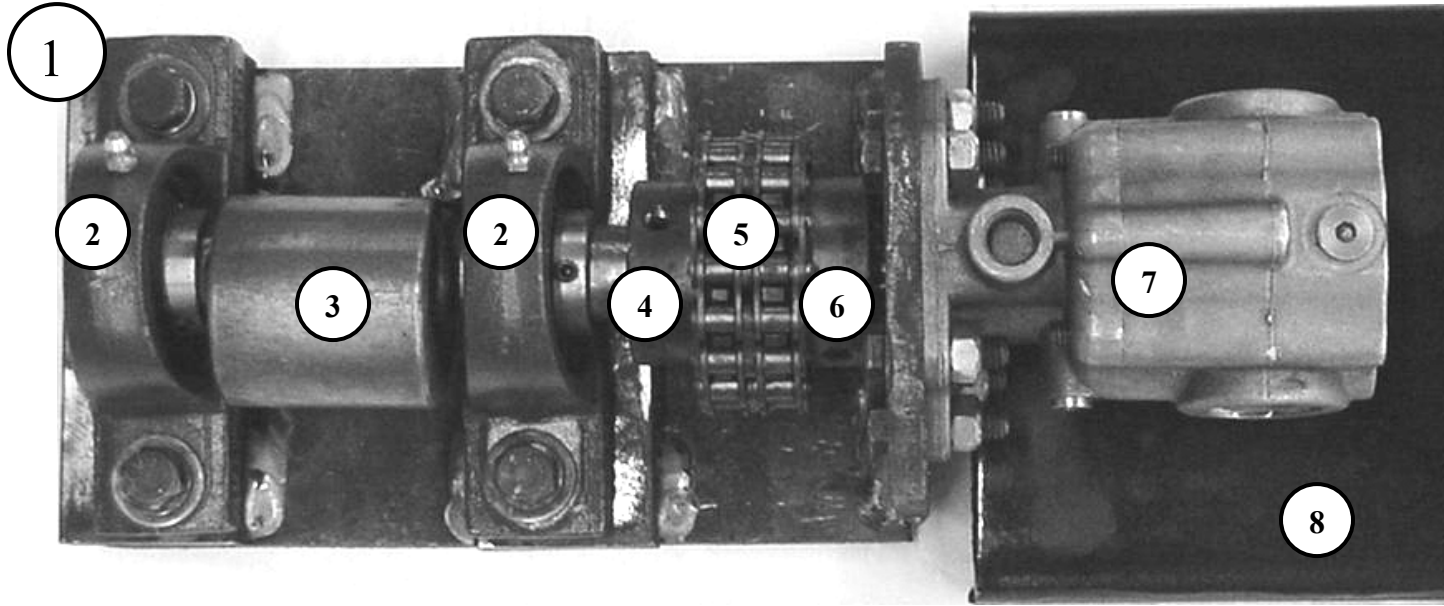

1. Vibrator Assembly Complete.....	090-0232
2. Pillow Block Bearing	018-0002
3. Vibrator Shaft.....	092-0074
4. Vibrator Shaft Coupling Half	015-0033
5. Coupling Chain	015-0044
6. Vibrator Motor Coupling Half.....	015-0119
7. Vibrator Motor	013-0055
8. Vibrator Assembly Cover	111-200076

Serial Number Range: 999-B-69TKS8Y2-00999 thru _____

TRACK ASSEMBLY

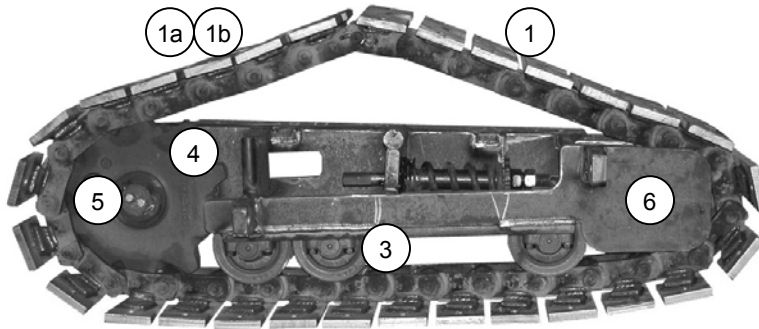

1. Track Chain Assembly (x2)092-0112
 - a. Track Link (with Pad) (x58) ...092-0118
 - b. Track Pad (Steel) (x58).....093-0025
2. Track Roller (x6).....050-0257
3. Track Tensioning System (x2).. See *Idler Assy.*
4. Drive Sprocket (x2)..... See *Drive Assy.*
5. Spacer Cap (x2) See *Drive Assy.*
6. Idler Sprocket (x2) (not shown). See *Idler Assy.*

TRACK IDLER ASSEMBLY

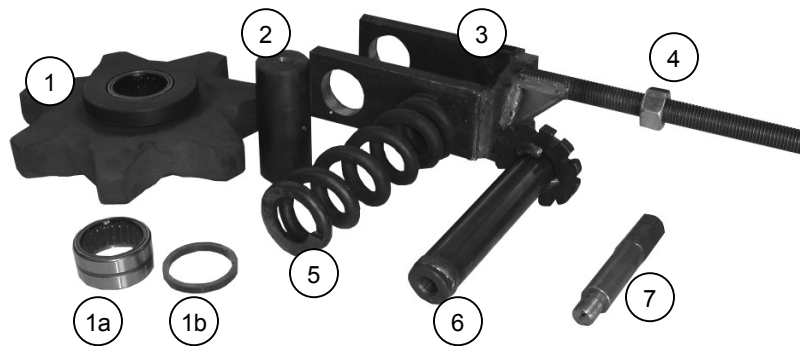

1. Idler Sprocket Assembly (x2)....093-0326
 - a. Idler Sprocket Bearing (x4) ...018-0097
 - b. Idler Sprocket Spacer (x2)093-0027A
2. Idler Sprocket Shaft (x2).....093-0026
3. Idler Yoke (x2)092-0033A
4. Idler Yoke Jam Nut (x2).....030-0034
5. Idler Yoke Tension Spring (x2) .050-0066
6. Idler Yoke Spring Adjuster (x2).092-100385
7. Idler Yoke Hex Bolt (x2).....093-100386

TRACK DRIVE ASSEMBLY

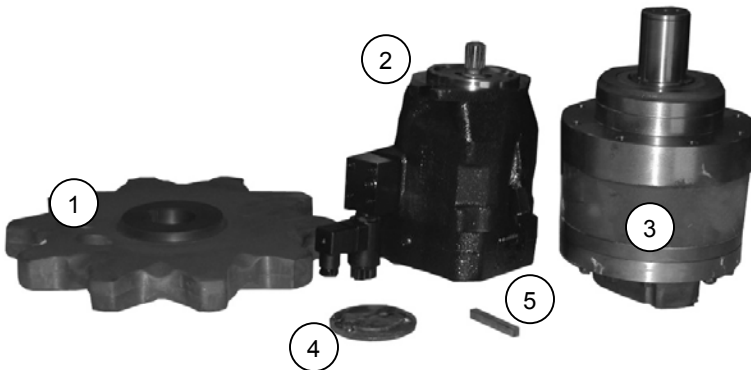

1. Drive Sprocket (x2).....093-0325
2. Drive Motor (x2).....013-0078
3. Planetary (x2)016-0047
4. Spacer Cap (x2)093-0028
5. Planetary Shaft Key (x2).....093-0019

Serial Number Range: 999-B-69TKS8Y2-00999 thru _____

BATTERY ASSEMBLY



- 1. Battery Retaining Rod (not shown)..... 093-0040
- 2. Mounting Rubber 015-0212
- 3. Battery..... 020-0019
- 4. Battery Cable (Positive)..... 020-0361
- 5. Battery Cable (Negative) 020-0318

PROPANE ASSEMBLY

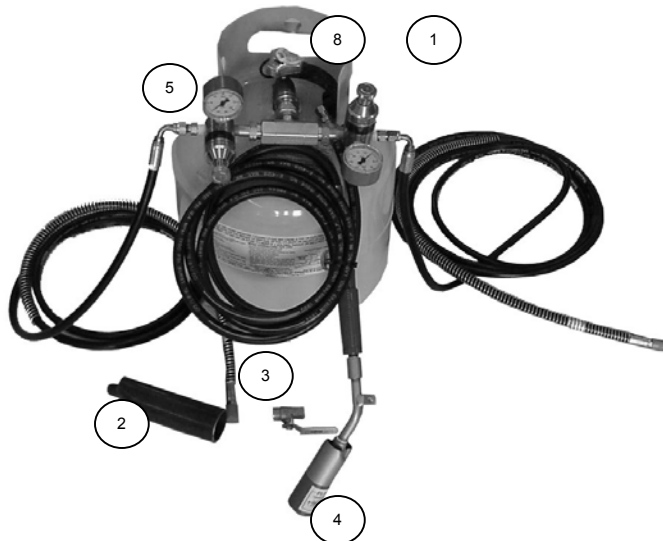

- 1. Propane Assembly090-0233
- 2. Scedd Burner Assembly (x4)093-0217
- 3. Ball Valve (x3)050-0154
- 4. Lighting Torch Assembly090-0231
- 5. Regulator (with gauge) (x2).....050-0049
- 6. Ext. Burner Propane Tubing (LH) (not shown) 111-200047
- 7. Ext. Burner Propane Tubing (RH) (not shown) ... 111-200046
- 8. Propane Tank.....050-0039

Serial Number Range: 999-B-69TKS8Y2-00999 thru _____

TIRE ASSEMBLY (Optional)

Rear

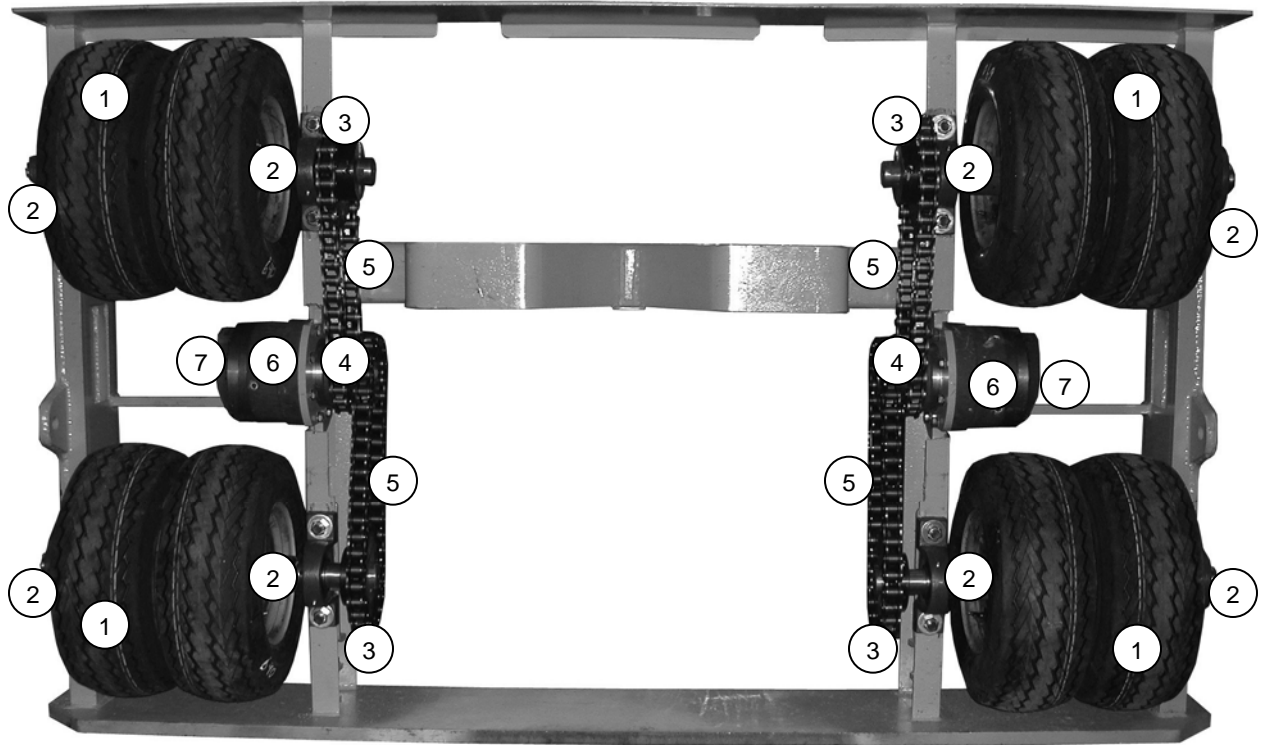

Front

- | | |
|---|----------------------|
| 1. Dual Tire and Axle Assembly (x4) | 092-0421 |
| 2. Axle Bearing (x8) | 018-0004 |
| 3. Axle Drive Sprocket (x4) | 015-0029 |
| 4. Planetary Drive Sprocket (x2) | 015-0224 |
| 5. Drive Chain (x4) | 091-0071 |
| 6. Planetary (x2) | See Track Drive Assy |
| 7. Drive Motor (x2) (not shown) | See Track Drive Assy |